



# EMPIRE

## TRADE EXCHANGE

### NATIONAL NEWSLETTER

July  
2010

Volume 4 - Issue 6

Image compliments of [www.freefoto.com](http://www.freefoto.com)

**IT'S HERE YET AGAIN...**

***The end of financial year can mean only one thing...***

**TAX TIME!**

why not have your tax return organised and lodged by one of the many professionals within the empire trade membership base?

This could save you a lot of cash PLUS you can claim the trade dollars for the service provided on next years return.

Contact Head Office on 07 5437 7220 or email [hq@au.empireXchange.com](mailto:hq@au.empireXchange.com) for a list of Members who offer their accountancy services on trade. Some offer up to 100% Trade!

***THINK TRADE FIRST***

**Have any of your details changed?...Please let us know!**

*Having all your details up to date allows us to offer you the best service possible!*

**DISCLAIMER:** While every care has been taken in preparing this publication, Empire Trade Exchange Pty Ltd (including its Executive Advisory Committee, associates and agents) will not accept any responsibility or liability to any person or corporation seeking to rely on any information, advice or opinion provided in this publication or otherwise given in any manner by the Executive Advisory Committee, associates and agents of Empire Trade Exchange Pty Ltd for any loss or damage of whatever nature suffered by any such person or corporation. No part of this publication may be reproduced in any manner without the permission of Empire Trade Exchange Pty Ltd.



# REAL ESTATE

New listings and properties available now  
[www.empireXchange.com](http://www.empireXchange.com)



Olympus Realty has a variety of residential, commercial and industrial properties as well as land and businesses for sale.  
Olympus Realty - Lic No. 3155275 ABN: 91 120 781 240 Address: PO Box 1173, Buddina QLD 4575  
Ph: 07 5437 7075 Fax: 07 5437 7231 Email: [realestate@olympusre.net](mailto:realestate@olympusre.net) Hours: Mon - Fri 9am - 5pm



## House & Land Packages - Gympie Qld

STAGE 2 PLAN  
&  
PRICE LIST

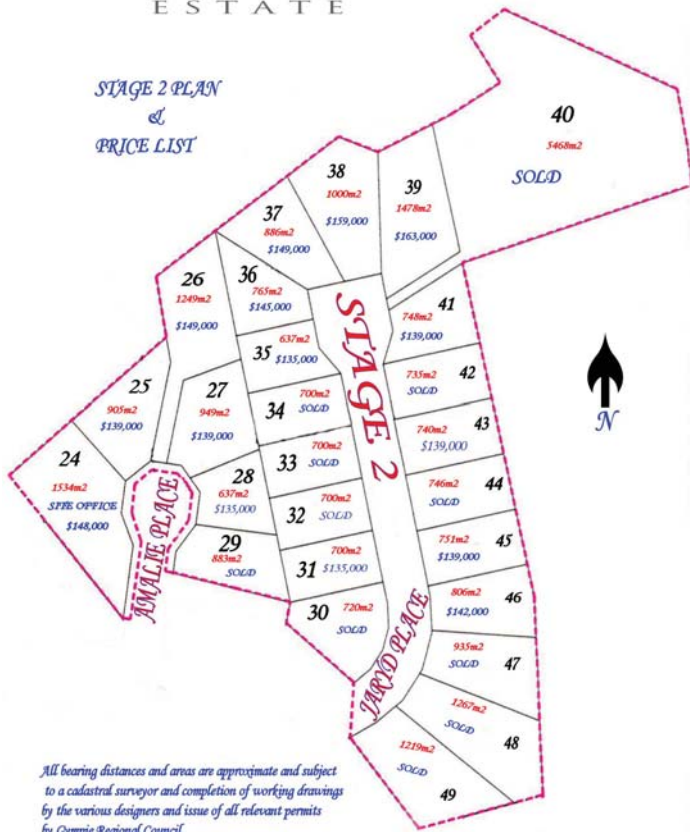

Off the plan House & Land Packages available in the Victory Heights Estate of Gympie Queensland.

3 bedroom, 2 bathroom, double lock up garage, floor coverings, light fittings, air conditioned, drive way, landscaping. Four designs to choose from.

**House & Land Packages start from \$360,000.00**

**Including 20% Empire Trade**

Contact Peter Rigley  
on 0413 874 872  
or email [peter@olympusre.net](mailto:peter@olympusre.net)

All bearing distances and areas are approximate and subject to a cadastral surveyor and completion of working drawings by the various designers and issue of all relevant permits by Gympie Regional Council.

## Hotel Site Close to Gympie

**5 Acres, Main highway position (20,000 vehicles pass daily)**

Service station nearby with reputed annual turnover of \$9,000,000.00 p.a

This site has development approvals for hotel & shops and is near a proposed caravan park.

**With over 2000 local residents and high traffic volume the site is well priced at \$1,500,000.00 Including 30% Empire Trade.**

Contact Peter Rigley on 0413 874 872 or email [peter@olympusre.net](mailto:peter@olympusre.net)



# FOREFRONT

Empire Trade Features for July 2010  
[www.empireXchange.com](http://www.empireXchange.com)

## AUCTION FEATURE

### SMALL OFFICE LASER PRINTER

Here is a Lexmark T620 A4 and envelope B&W Laser Printer that is in good working condition ideal for a small office. Test page is excellent and it comes with its paper tray, toner plus USB and network inputs. From a closed office and ready to go with 15% of toner and a print count of only 137,231.

### 50% EMPIRE TRADE

This Auction closes: AEST 15:51:09, Fri 9th Jul 2010



To bid on or list items of your own go to [www.empireXchange.com](http://www.empireXchange.com) and login with your username and password.

## CLASSIFIED FEATURE



### GOLD COAST - OFFICE SPACE FOR LEASE

OFFICE SPACE TO LEASE 3+3 TERMS NEG.  
BRAND NEW BUILDING 66SM.  
OWNER WILL SPEND \$20,000 ON FIT OUT FOR CLIENT.  
PREMIUM CBD OFFICE

PRICED AT: \$23,000.00  
\$11,500.00 CASH + \$11,500.00 TRADE

CONTACT LYNETTE & IAN SOUTHERN ON 07 5578 1551  
OR EMAIL [LAMBCHOP259@HOTMAIL.COM](mailto:LAMBCHOP259@HOTMAIL.COM)

To list or view items of go to [www.empireXchange.com](http://www.empireXchange.com) and login with your username and password.

## CATALOGUE FEATURE

### Downunder 7" Rod & Reel

Model No- HCDU701SB- Downunder 7' 2pc spin boat rod, 6-10kg  
w/Hawk Koshin 5000, 7+1 bearing, dual drag, boxed spare spool

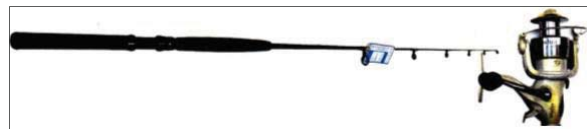

**Priced at: \$172.00 (\$86.00 cash + \$86.00 trade)**

Contact Marlene on 0407 391 327 or email [marlene1234@bigpond.com](mailto:marlene1234@bigpond.com)

To list or view items of go to [www.empireXchange.com](http://www.empireXchange.com) and login with your username and password.



# FOREFRONT

Empire Trade Member Specials for July 2010  
[www.empireXchange.com](http://www.empireXchange.com)

## Corporate & Novelty Clocks

Promote your business or special event by having your logo manufactured into clocks! Include your website & phone numbers so your valued customers have it on hand every time they look at the time! Your clients will subliminally see your logo every time they look at the clock! What a great way for your business to be seen. Fabulous give away items for your best clients. Each clock is finished with a gloss or matt finish. Limited stocks available so don't delay to take advantage of this great offer.

### Sizes

- \* A . rectangular A4 size (aluminium)
- \* B - Circular Wall Hanging (mdf)
- \* C - Circular Self Standing (mdf)

### Prices

#### A . rectangular A4 size (aluminium)

- \* \$99 - 1 unit (artwork supplied by buyer)
- \* \$700 - 10 units (artwork Included)
- \* \$1200 - 20 units (artwork included) \$60 each plus GST

#### B - Circular Wall Hanging (mdf)

- \* \$99 - 1 unit (artwork supplied by buyer)
- \* \$700 - 10 units (artwork included)
- \* \$1200 - 20 units (artwork included)\$60 each plus GST

#### C - Circular Self Standing (mdf)

- \* \$110 - 1 unit (artwork supplied by buyer)
- \* \$799 - 10 units (artwork included)
- \* \$1450 - 20 units (artwork included) \$72.59 each plus GST

\* Prices subject to GST

\* Does not include packing or delivery



**Offering 50% Empire Trade**

Contact: Geoffrey Hupfeld on 07 5530 5569

Email: [barter@chalkart.com.au](mailto:barter@chalkart.com.au)

Address: 85 Tallai Road, Tallai Qld 4213

Website: [www.chalkart.com.au](http://www.chalkart.com.au)



**Mobile Phone accounts on  
33% trade**

Contact us for call rates and charges.

Phone Les Howard on 07 3272 5690 or email  
[sales@perfectiontelecom.com.au](mailto:sales@perfectiontelecom.com.au)

## JSI MORTGAGE SPECIALISTS

Mortgage Broker  
Financial Consultant  
Specialist in Residential Investment

Offering **100% Trade** to all Members

Contact: Kevin Lockwood on 07 5579 9677  
Address: 26 Campbell St, Sorrento Qld 4217  
Email: [jsimortgage@bigpond.com](mailto:jsimortgage@bigpond.com)



# MEMBER'S MARKET

Empire Trade Member Specials for July 2010  
[www.empireXchange.com](http://www.empireXchange.com)

**AUSTRALIA WIDE - AUSTRALIA WIDE - AUSTRALIA WIDE - AUSTRALIA WIDE**

We are a  Member!

## William McIntosh Motor Lodge



**Accommodation at Naracoorte 3 1/2 star Comfort Inn**

Don't delay book now and enjoy our friendly service and atmosphere

Offering **100% Trade for Gold Club** Members  
and **50% Trade** for 50% Club and non Club Members

Contact: Mario D'Aloia on 08 8762 1644

Address: 20 Stewart Tce, Naracoorte SA 5271

Email: [info@william-macintosh.com.au](mailto:info@william-macintosh.com.au)

Website: [www.william-macintosh.com.au](http://www.william-macintosh.com.au)

## Summertime Cottages Tasmania

Beachfront Holiday House - Tasmania.

Panoramic waterfront beach cottage southern Tasmania, romantic setting. Safe clean and sandy beach, great fishing. Self contained with open fire. Very charming, ideal artists / musicians retreat or great for health retreat. For local attractions go to [www.farsouthtasmania.com](http://www.farsouthtasmania.com)



Offering **100% Trade for Gold Club** Members  
and **75% Trade for all other** Members

Contact: Roger McMillan on 0410 583 213  
120 Kingfish Beach Rd, Southport Far South  
Tasmania 7109

Email: [rogerm@netconnect.com.au](mailto:rogerm@netconnect.com.au)

Website: [www.summertimecottage.net](http://www.summertimecottage.net)



# MEMBER'S MARKET

Empire Trade Member Specials for July 2010  
[www.empireXchange.com](http://www.empireXchange.com)

## AUSTRALIA WIDE - AUSTRALIA WIDE - AUSTRALIA WIDE - AUSTRALIA WIDE

### Noosaville Accommodation available on 50% Trade

This beautiful 2 bedroom townhouse (with study and fold out bed) is situated close to the Noosa River and marina. It is available to rent with 50% Trade. The complex comprises of 3 pools, tennis court, spa & sauna.



Contact Brett on (07) 3277 6533

email: [brett@brettcon.com.au](mailto:brett@brettcon.com.au)



### Active H2O

Marble, Limestone and Granite Tiles.

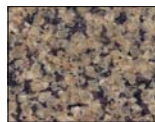

Various colours and sizes approx 70% trade, ongoing supply.



Visit website to view product range  
[www.activeh2o.com.au](http://www.activeh2o.com.au)

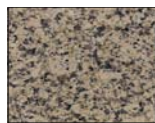

Offering 70% Empire Trade



Contact: Kerry Bryon on 02 6259 6093  
Address: Dunlop ACT 2615  
Email: [trader@telair.com.au](mailto:trader@telair.com.au)  
Web: [www.activeh2o.com.au](http://www.activeh2o.com.au)

We are a  Member!

### Richard Rose

We stock a wide range of mower parts such as blade and bolt sets.

We also stock made up chains, including 3/8 pitch to fit a saw with 20 inch bar which has 72 drivelinks- will freight Nationally at buyer's expense in cash.

Please call to find out how we can help you.

### Offering 50% Empire Trade

Contact: Richard Rose on 0403 357 810  
Email: [barhardw@dodo.com.au](mailto:barhardw@dodo.com.au)



# MEMBER'S MARKET

Empire Trade Member Specials for July 2010  
[www.empireXchange.com](http://www.empireXchange.com)

**AUSTRALIA WIDE - AUSTRALIA WIDE - AUSTRALIA WIDE - AUSTRALIA WIDE**

## Recycled Golf Balls



As a regular golfer you know that the best ball you can afford will make a big difference to your game. But new balls are expensive and don't always finish the round with you. We offer the best quality A, B and C Grade - recycled golf balls.

### A Grade - \$3 each 50% Empire Trade

Our A Grade quality recycled golf balls are the best available and enable you to afford great balls to optimize your performance. They are the choice for many golfers regardless of skill level. The A Grade balls look and feel like brand new balls, you'll probably think they've only been used on one hole! There are no X Outs but you may get some balls with slight discolouration, corporate or sport team logos and player markings. NOTE: We do not sort balls by year or name of manufacture . All orders will be a mix of brand names.

### B Grade - \$2 each 50% Empire Trade

B Grade recycled golf balls are clean, playable and may have moderate surface blemishes and player ink marks, corporate or sport team logos or discolouration. The blemishes will not affect the ball's design and playability. Although these balls are slightly cosmetically challenged, they have no significant cuts or creases. They are similar to a ball you've played a few holes with, so you'll still be able to shoot your best score with these!. NOTE: We do not sort balls by year or name of manufacture . All orders will be a mix of brand names.

### C Grade - \$1 each 50% Empire Trade

Our C Grade recycled golf balls are the best value buy. While they may have surface blemishes and discolouration and corporate or sport team logos, they have no serious cuts or damage and are totally playable. X outs and Practice balls may be included in the mix. These are great knock about balls for casual golfers or the kids! NOTE: We do not sort balls by year or name of manufacture . All orders will be a mix of brand names.

Minimum order 20 balls

All orders under 50 balls will be sent Aust Post COD

All orders over 50 balls will be sent FREE with Fastway Couriers

Bulk order enquiries welcome!

Please phone Alby Koster on 02 6651 9828 or email [expense@internode.on.net](mailto:expense@internode.on.net) for ordering details.



## Eco Bond Coatings

**ECO BOND COATINGS has just produced the first fire proof heat reflective flexible render.**

**POLYREND:** a pre-blended, high solids, thin screed, flexible render which is heat resistant and fire resistant.  
Can freight Nationally at buyer's expense in cash.

Offering **30% Trade** to all members.

Paul Humphries & Mario D'Aloia on 08 8351 4934 Email: [sales@ecobondcoatings.com](mailto:sales@ecobondcoatings.com)

22 Blackburn St, Orchard Everard Park SA 5035 Website: [www.ecobondcoatings.com](http://www.ecobondcoatings.com)



# MEMBER'S MARKET

Empire Trade Member Specials for July 2010  
[www.empireXchange.com](http://www.empireXchange.com)

**AUSTRALIA WIDE - AUSTRALIA WIDE - AUSTRALIA WIDE - AUSTRALIA WIDE**

## EZY PROMOTIONS

For all your promotional products such as pens, rulers, key tags, mugs etc. We can do laser engraving, digital labels and resin doming. Check out our website [www.ezypromotions.com.au](http://www.ezypromotions.com.au)



Offering **50% Trade** to all Members

Contact: John Gordon on 0418 756 168

Email: [colingordon1@bigpond.com](mailto:colingordon1@bigpond.com)

Address: Helensvale Qld 4212

Website: [www.ezypromotions.com.au](http://www.ezypromotions.com.au)

### Fasta Mortgage Solutions

- Mortgage Finance
- Investment Finance
- Mortgage Reduction & Wealth Creation Programs
- Refinance & Debt Consolidation

Offering **up to 100% Trade** depending on type of service required

Contact: Gerard McDonald on 0404 018 309

Address: 4 Stirling Court, Bonogin Qld 4213

Email: [gmcdonald88@gmail.com](mailto:gmcdonald88@gmail.com)

### Professional Accountancy Services Pty Ltd

**Accountant** - CPA.GST Advice, Export Planning Service, Business Planning, Financial Planning, Investment Advice, Proper Authority, Legitimate Offshore Structures.

**100% Trade for Gold Club Members**  
**50% Trade for 50% Club Members and non Club Members**

Contact: Paul Kinasch on 07 5598 7733

Address: 48/74 Galleon Way, Currumbin Waters QLD 4223

Email: [paul\\_k@virginbroadband.com.au](mailto:paul_k@virginbroadband.com.au)





# MEMBER'S MARKET

Empire Trade Member Specials for July 2010  
[www.empireXchange.com](http://www.empireXchange.com)

**AUSTRALIA WIDE - AUSTRALIA WIDE - AUSTRALIA WIDE - AUSTRALIA WIDE**

We are a **50% Plus Club** Member!

## REID REMOVALS

For the best move you'll ever make

### WE WANT YOUR BUSINESS!

Furniture removalist - owner operator.  
Backloading from Cairns to Melbourne and everywhere in-between. All stops - door to door.

- We specialise in pianos & antiques.
- Storage, packing materials available.
- No containers. No Subcontractors.

Need more info? Visit our website  
[www.reidremovals.com.au](http://www.reidremovals.com.au)



Offering **50% Trade** to all Members

Contact: Pamela Reid on 07 4124 7500  
222 Denman Camp Road, Hervey Bay Qld 4655  
Email: [reidremovals@optusnet.com.au](mailto:reidremovals@optusnet.com.au)  
Website: [www.reidremovals.com.au](http://www.reidremovals.com.au)

## Golf Ebook

### Your Perfect Plan for Practice and Play

### Surprise your golf buddies by your vast improvement

This Golf Ebook leaves no stone unturned, covering all aspects of your game.

Track your game and address each area step by step.

PGA Golf Professional and author **Doug Kercher** guarantees results.

\* 260 page plus manual containing charts and trackers.

\* Great gift ... downloadable PDF file.

\* View on screen or print out.

**Priced at: \$60 - 100% Empire Trade**

To purchase we'll need an email from you  
[dougkpga@gmail.com](mailto:dougkpga@gmail.com)



#### Trading Suspensions and Businesses no longer with the Exchange

**PLEASE NOTE THAT OUR USUAL GUARANTEE TO HONOUR AMOUNTS UP TO \$T200 WITHOUT AUTHORISATION WILL NOT APPLY TO TRANSACTIONS WITH THE ACCOUNTS LISTED BELOW.**

#### TRADING SUSPENSIONS

The member accounts listed below have been suspended from trading during the month of July 2010. Please do not accept any transactions from these members without first calling for authorisation regardless of the amount.

Without an authorisation, the transaction will not be honoured by Empire Trade. **This list will be updated monthly.**

11297 La Castle Pty Ltd  
16322 Australian Workforce Pty L  
19223 JAG New & Used PC's

26028 Signs and More  
28472 Bredbury Pty Ltd  
30050 Ben Sutherland Constructions

30135 Classique Stiletto  
30253 Solitaire  
30349 NV Phones

#### BUSINESSES NO LONGER IN THE EMPIRE TRADE EXCHANGE

The following businesses are no longer members of our exchange. In most part, these are businesses that have sold or closed. These are permanent deletions and transactions by these businesses will not be honoured by Empire Trade.

12915 Commex Concepts Pty Ltd  
13443 Jeffs Bedside Manor  
17137 Exceptional Building Products

17763 Sportspower  
21052 Iron Bark Riding Centre  
23023 Silveradoh Promotional Products

25918 Windsor Motel  
27774 Ascot Motor Inn  
29909 X-Mod Monitoring Security



**EMPIRE**  
TRADE EXCHANGE



## Australian Contacts

**HEAD OFFICE - Sunshine Coast | Unit 1 / 17 Premier Circuit Kawana Junction QLD 4575 | PO BOX 151 Buddina QLD 4575**  
Tel: 07 5437 7220 | Fax: 07 5437 7230 | Email: [hq@au.empireXchange.com](mailto:hq@au.empireXchange.com)

### ACT

Canberra - | Tel: 07 5437 7220 - after the prompt dial 121 | [canberra@au.empireXchange.com](mailto:canberra@au.empireXchange.com)

### NEW SOUTH WALES

**NSW Mid North Coast** - | Tel: 07 5437 7220 - after the prompt dial 124 | [nswmidcoast@au.empireXchange.com](mailto:nswmidcoast@au.empireXchange.com)  
**Newcastle - Phillip Brown** | Tel: 02 4942 2291 | [newcastle@au.empireXchange.com](mailto:newcastle@au.empireXchange.com)  
**NSW Central Coast** - | Tel: 07 5437 7220 - after the prompt dial 124 | [nswcentcoast@au.empireXchange.com](mailto:nswcentcoast@au.empireXchange.com)  
**NSW Regional South - Lana Rawiri** | Tel: 07 5437 7220 - after the prompt dial 121 | [nswre@au.empireXchange.com](mailto:nswre@au.empireXchange.com)  
**Sydney West** - | Tel: 07 5437 7220 - after the prompt dial 121 | [sydney@au.empireXchange.com](mailto:sydney@au.empireXchange.com)  
**Sydney North Shore** - | Tel: 07 5437 7220 - after the prompt dial 121 | [sydney@au.empireXchange.com](mailto:sydney@au.empireXchange.com)  
**Sydney City** - | Tel: 07 5437 7220 - after the prompt dial 121 | [sydney@au.empireXchange.com](mailto:sydney@au.empireXchange.com)

### QUEENSLAND

**Brisbane - Dean Knezevic** | Tel: 07 5437 7220 - after the prompt dial 111 | [brisbane@au.empireXchange.com](mailto:brisbane@au.empireXchange.com)  
**Caboolture - Kym Saron & Mick James** | Tel: 07 5437 7220 - after the prompt dial 112 | [caboolture@au.empireXchange.com](mailto:caboolture@au.empireXchange.com)  
**Sunshine Coast & Gympie - Kym Saron & Mick James** | Tel: 07 5437 7220 - after the prompt dial 112 | [suncoast@au.empireXchange.com](mailto:suncoast@au.empireXchange.com)  
**Gold Coast - Lance Reinhardt** | Tel: 07 5437 7220 - after the prompt dial 113 | [goldcoast@au.empireXchange.com](mailto:goldcoast@au.empireXchange.com)  
**Wide Bay & Burnett - Lance Reinhardt** | Tel: 07 5437 7220 - after the prompt dial 114 | [widebay@au.empireXchange.com](mailto:widebay@au.empireXchange.com)

### SOUTH AUSTRALIA

**Paul Humphries** | Tel: 08 8381 5014 | Mob: 0410 317 753 | [adelaide@au.empireXchange.com](mailto:adelaide@au.empireXchange.com)  
**Member Support - Jane Meade-Radford** | Tel: 07 5437 7220 - after the prompt dial 15 | [jane.m@au.empireXchange.com](mailto:jane.m@au.empireXchange.com)

### TASMANIA

Tasmania - Jane Meade-Radford | Tel: 07 5437 7220 - after the prompt dial 16 | [tas@au.empireXchange.com](mailto:tas@au.empireXchange.com)

### VICTORIA

**Albury / Wodonga - Lana Rawiri** | Tel: 07 5437 7220 - after the prompt dial 133 | [alburywodonga@au.empireXchange.com](mailto:alburywodonga@au.empireXchange.com)  
**Ballarat - Lana Rawiri** | Tel: 07 5437 7220 - after the prompt dial 133 | [ballarat@au.empireXchange.com](mailto:ballarat@au.empireXchange.com)  
**Bendigo - Lana Rawiri** | Tel: 07 5437 7220 - after the prompt dial 133 | [bendigo@au.empireXchange.com](mailto:bendigo@au.empireXchange.com)  
**Geelong - Lana Rawiri** | Tel: 07 5437 7220 - after the prompt dial 133 | [geelong@au.empireXchange.com](mailto:geelong@au.empireXchange.com)  
**Melbourne - Sonia Oakley** | Tel: 07 5437 7220 - after the prompt dial 131 | [melnorth@au.empireXchange.com](mailto:melnorth@au.empireXchange.com)  
**Mornington Peninsula / Melbourne South - Sonia Oakley** | Tel: 07 5437 7220 - after the prompt dial 132 | [mornington@au.empireXchange.com](mailto:mornington@au.empireXchange.com)  
**Shepparton / Goulburn Valley - Lana Rawiri** | Tel: 07 5437 7220 - after the prompt dial 133 | [shep@au.empireXchange.com](mailto:shep@au.empireXchange.com)

### WESTERN AUSTRALIA

Western Australia - Jane Meade-Radford | Tel: 07 5437 7220 - after the prompt dial 14 | [wa@au.empireXchange.com](mailto:wa@au.empireXchange.com)

## International Contacts

**HUNGARY - Maria Toth and Ivett Firan** | Tel: +64 732 646 808 or +36 2935 1137 | [hq@hu.ebanctrade.com](mailto:hq@hu.ebanctrade.com)  
**MALAYSIA - Esther Loh** | Tel: +60 3 7781 0233 | [hqmsia@eplanettrade.com](mailto:hqmsia@eplanettrade.com)  
**NETHERLANDS & BELGIUM - International Head Office** | Tel: +61 7 5437 7220 | [hq@nl.ebanctrade.com](mailto:hq@nl.ebanctrade.com)  
**NEW ZEALAND - James Hobcraft** | Tel: +64 3 930 4772 | [hq@nz.empireXchange.com](mailto:hq@nz.empireXchange.com)  
**SPAIN - Pablo Salgado** | Tel: +34 900 101 192 | [hq@es.ebanctrade.com](mailto:hq@es.ebanctrade.com)  
**UNITED KINGDOM - Intl Head Office** | Tel: +61 7 5437 7220 | [hq@uk.empireXchange.com](mailto:hq@uk.empireXchange.com)  
**VIETNAM - Head Office** | Tel: 07 5437 7220 | [hq@au.empireXchange.com](mailto:hq@au.empireXchange.com)